

# Линии гладильные автоматические для брюк MACPI 509.33.1114

## Технические характеристики

Алматы (7273)495-231  
Ангарск (3955)60-70-56  
Архангельск (8182)63-90-72  
Астрахань (8512)99-46-04  
Барнаул (3852)73-04-60  
Белгород (4722)40-23-64  
Благовещенск (4162)22-76-07  
Брянск (4832)59-03-52  
Владивосток (423)249-28-31  
Владикавказ (8672)28-90-48  
Владимир (4922)49-43-18  
Волгоград (844)278-03-48  
Вологда (8172)26-41-59  
Воронеж (473)204-51-73  
Екатеринбург (343)384-55-89

Иваново (4932)77-34-06  
Ижевск (3412)26-03-58  
Иркутск (395)279-98-46  
Казань (843)206-01-48  
Калининград (4012)72-03-81  
Калуга (4842)92-23-67  
Кемерово (3842)65-04-62  
Киров (8332)68-02-04  
Коломна (4966)23-41-49  
Кострома (4942)77-07-48  
Краснодар (861)203-40-90  
Красноярск (391)204-63-61  
Курск (4712)77-13-04  
Курган (3522)50-90-47  
Липецк (4742)52-20-81

Магнитогорск (3519)55-03-13  
Москва (495)268-04-70  
Мурманск (8152)59-64-93  
Набережные Челны (8552)20-53-41  
Нижний Новгород (831)429-08-12  
Новокузнецк (3843)20-46-81  
Ноябрьск (3496)41-32-12  
Новосибирск (383)227-86-73  
Омск (3812)21-46-40  
Орел (4862)44-53-42  
Оренбург (3532)37-68-04  
Пенза (8412)22-31-16  
Петрозаводск (8142)55-98-37  
Псков (8112)59-10-37  
Пермь (342)205-81-47

Ростов-на-Дону (863)308-18-15  
Рязань (4912)46-61-64  
Самара (846)206-03-16  
Саранск (8342)22-96-24  
Санкт-Петербург (812)309-46-40  
Саратов (845)249-38-78  
Севастополь (8692)22-31-93  
Симферополь (3652)67-13-56  
Смоленск (4812)29-41-54  
Сочи (862)225-72-31  
Ставрополь (8652)20-65-13  
Сыктывкар (8212)25-95-17  
Тамбов (4752)50-40-97  
Сургут (3462)77-98-35  
Тверь (4822)63-31-35

Тольятти (8482)63-91-07  
Томск (3822)98-41-53  
Тула (4872)74-02-29  
Тюмень (3452)66-21-18  
Ульяновск (8422)24-23-59  
Улан-Удэ (3012)59-97-51  
Уфа (347)229-48-12  
Хабаровск (4212)92-98-04  
Чебоксары (8352)28-53-07  
Челябинск (351)202-03-61  
Череповец (8202)49-02-64  
Чита (3022)38-34-83  
Якутск (4112)23-90-97  
Ярославль (4852)69-52-93

Россия (495)268-04-70

Казахстан (772)734-952-31

Киргизия (996)312-96-26-47

# Automatic trouser-line



# Trouser-line

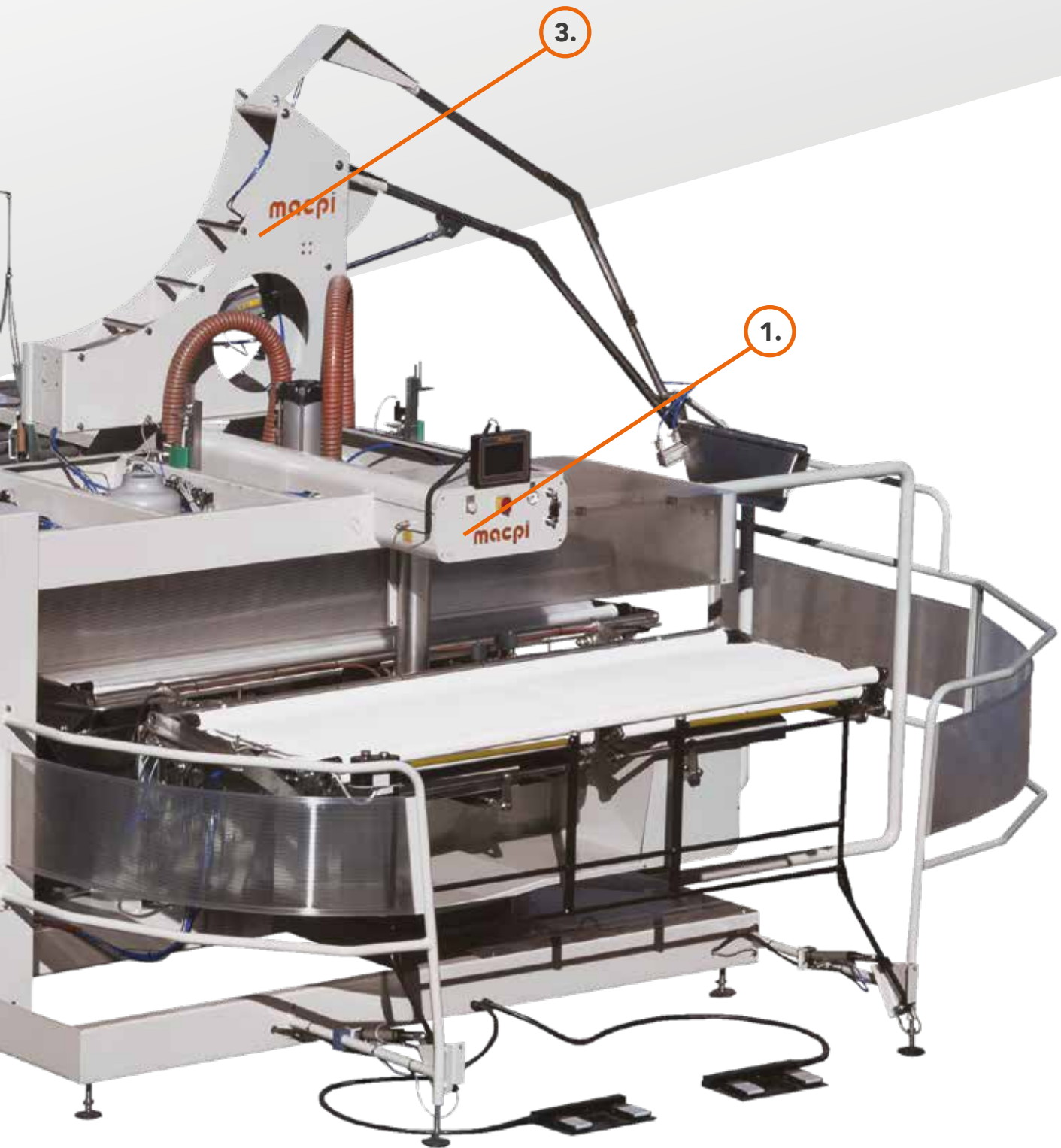

# Automatic trouser-line



Programmatore touch-screen a colori TCW 7" con porta USB e Wi-fi removibile  
Full color touch screen programmer TCW 7" with USB and Wi-fi

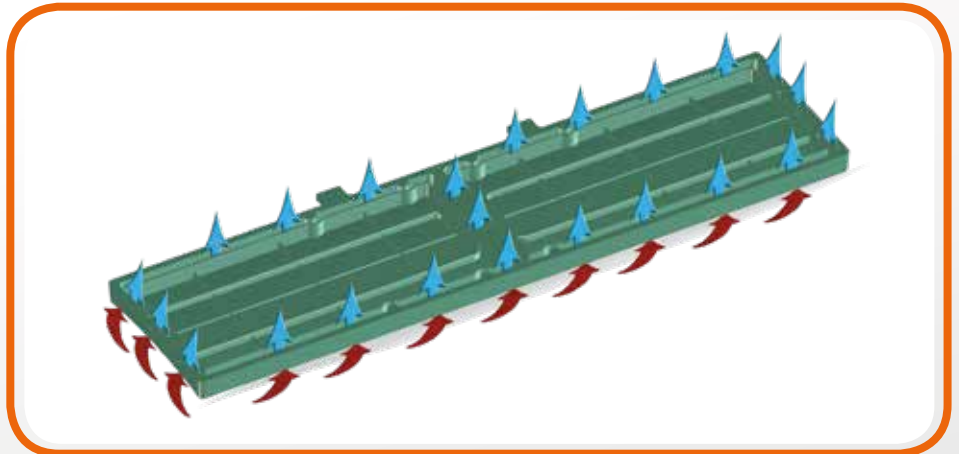

Vacsteam incorporato

Di serie, per le forme previste, i caroselli MACPI montano un sistema di aspirazione sul bordo della forma che evita le impressioni lasciate dall'eccesso di vapore.

Built-in vacsteam

Macpi carousels are fitted (on forseen shapes) with a special vac-steam system on the edge of the shape to avoid the impressions left by the exceeding steam.

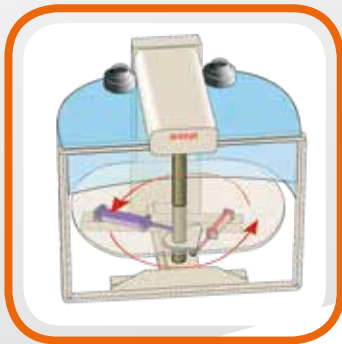

Rotazione veloce, ottenuta con l'applicazione di sistemi, pneumatici di spinta e oleodinamici di frenata.

Fast rotation thanks to the pneumatic pushing system and oleodynamic stopping

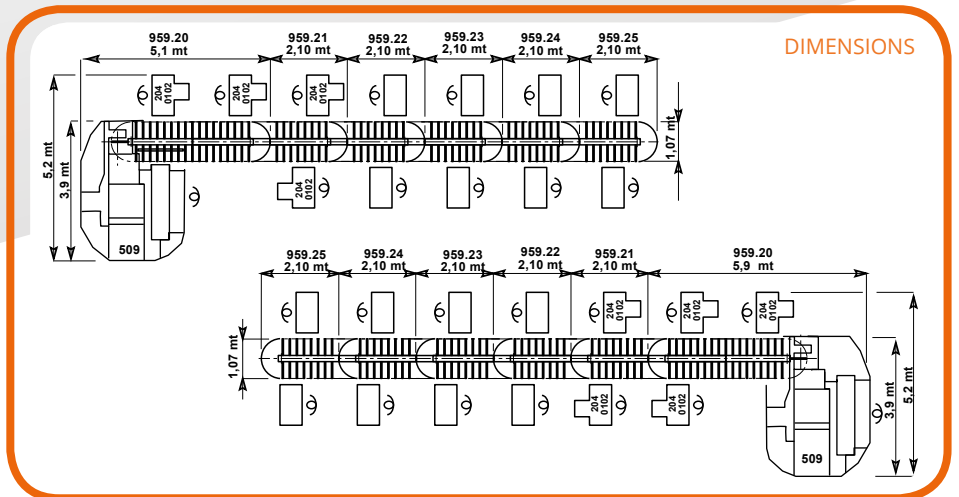

Qua a lato vediamo illustrato il principio di funzionamento del sofisticato pivot di ultima generazione montato sul carosello Macpi 509.33.1114 che permette di ottenere una qualità superiore nello stiro gamba pantalone.

I suoi movimenti si riassumono in tre fasi distinte:

- A) chiusura pivot
- B) discesa verticale
- C) trazione tele

The principles of the new stretching device fitted on the new carousel Macpi 509.33.1114 are here well indicated. It grants a far superior quality in the trousers' finishing.

Here below the flapper screen sequence:

- A) flapper screen closure
- B) vertical approaching
- C) stretch fabric traction

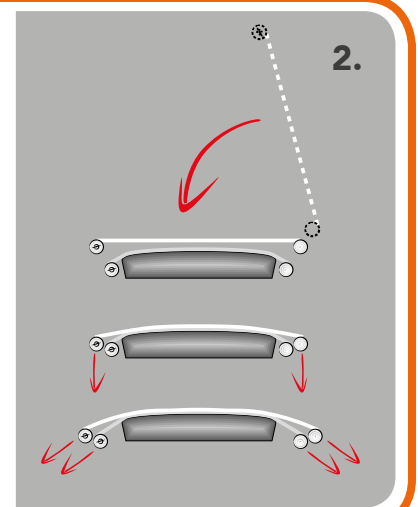

# Trouser-line



## Trouser line

Trouser line è il sistema ideale per lo stiro del pantalone che offre i seguenti vantaggi:

- alta produttività ed economia di esercizio grazie all'automazione dei trasporti intermedi fra stiro gambe e stiro bacino.
- garanzia di qualità in quanto il capo non viene manipolato, non subisce stoccaggi intermedi, ma ha il tempo necessario per stabilizzarsi fra le operazioni di stiro.
- compattezza in quanto lo "stiro gambe" è strettamente legato allo "stiro bacino".
- sincronismo fra le operazioni di stiro che si svolgono in successione anche in caso di assenza temporanea di uno o più operatori.

Il sistema prevede l'impiego di uno dei diversi tipi di caroselli stiro gambe:

(1) **Macpi** 509.33.1114 rettilinea con ogni forma inferiore dotata di pivot tensionabile pneumaticamente, con discesa verticale e (2) regolazione della tensione automatica. Tutti i pivot sono dotati di meccanismo per la ripresa lentezze tessuto.

N.B. : le macchine possono essere usate anche singolarmente "senza scarico automatico e trasportatore".

(3) Scaricatore automatico

(4) Trasportatore intermedio fornibile in diverse lunghezze e disposizioni.

(5) Pressa macpi per lo stiro bacino in quantità variabile in funzione dei capi da produrre.



## Trouser line

The trouser line is the ultimate solution for trousers finishing which offers several advantages:

- high productivity and cost savings thanks to the fully automated movement from leg pressing carousel to top trousers pressing machines
- high quality thanks by the total absence of trousers' handling and intermediate stockpiling. The trousers have enough time to stabilize during the different finishing stages
- synchronized pressing operations which can be carried on even if one or more operators are temporary out of station.

The line is designed as follows one of the carousel available in Macpi range is:

(1) **Macpi** 509.33.1114 complete with stretching flapper screen pneumatically controlled with vertical approaching (2) and automatic stretching control. Possibility to recover the loosing stretch fabric. Note: both machines 509.00 and 509.33 can be purchased separately without off-loader and conveyor system.

(3) Automatic off-loader

(4) Rotating conveyor available in different lengths. It can be placed in the front or back of the carousel machine.

(5) Macpi top trouser finishing machines (quantity to be selected in according to the production output).

## Technical details

**509.**      **Dimension:** (mm W x H x D) 3260 x 1690 x 3195 | **Weight:** 1800 Kg  
**Compressed air:** pipe connection 1x ø16 mm | **Pressure** 6 ATE | **Consumption** 173NL/min  
**Electric power:** 1,5Kw | **Consumption** 1,1Kw/h  
**Steam:** pipe connection 1x ø1/2" GAS | **Pressure** 5 ATE | **Consumption** 40Kg/h

Note: size, consumption, weight, depend from specific model

Алматы (7273)495-231  
Ангарск (3955)60-70-56  
Архангельск (8182)63-90-72  
Астрахань (8512)99-46-04  
Барнаул (3852)73-04-60  
Белгород (4722)40-23-64  
Благовещенск (4162)22-76-07  
Брянск (4832)59-03-52  
Владивосток (423)249-28-31  
Владикавказ (8672)28-90-48  
Владимир (4922)49-43-18  
Волгоград (844)278-03-48  
Вологда (8172)26-41-59  
Воронеж (473)204-51-73  
Екатеринбург (343)384-55-89

Иваново (4932)77-34-06  
Ижевск (3412)26-03-58  
Иркутск (395)279-98-46  
Казань (843)206-01-48  
Калининград (4012)72-03-81  
Калуга (4842)92-23-67  
Кемерово (3842)65-04-62  
Киров (8332)68-02-04  
Коломна (4966)23-41-49  
Кострома (4942)77-07-48  
Краснодар (861 )203-40-90  
Красноярск (391)204-63-61  
Курск (4712)77-13-04  
Курган (3522)50-90-47  
Липецк (4742)52-20-81

Магнитогорск (3519)55-03-13  
Москва (495)268-04-70  
Мурманск (8152)59-64-93  
Набережные Челны (8552)20-53-41  
Нижний Новгород (831)429-08-12  
Новокузнецк (3843)20-46-81  
Ноябрьск (3496)41-32-12  
Новосибирск (383)227-86-73  
Омск (3812)21-46-40  
Орел (4862)44-53-42  
Оренбург (3532)37-68-04  
Пенза (8412)22-31-16  
Петрозаводск (8142)55-98-37  
Псков (8112)59-10-37  
Пермь (342)205-81-47

Ростов-на-Дону (863)308-18-15  
Рязань (4912)46-61-64  
Самара (846)206-03-16  
Саранск (8342)22-96-24  
Санкт-Петербург (812)309-46-40  
Саратов (845)249-38-78  
Севастополь (8692)22-31-93  
Симферополь (3652)67-13-56  
Смоленск (4812)29-41-54  
Сочи (862)225-72-31  
Ставрополь (8652)20-65-13  
Сыктывкар (8212)25-95-17  
Тамбов (4752)50-40-97  
Сургут (3462)77-98-35  
Тверь (4822)63-31-35

Тольятти (8482)63-91-07  
Томск (3822)98-41-53  
Тула (4872)74-02-29  
Тюмень (3452)66-21-18  
Ульяновск (8422)24-23-59  
Улан-Удэ (3012)59-97-51  
Уфа (347)229-48-12  
Хабаровск (4212)92-98-04  
Чебоксары (8352)28-53-07  
Челябинск (351 )202-03-61  
Череповец (8202)49-02-64  
Чита (3022)38-34-83  
Якутск (4112)23-90-97  
Ярославль (4852)69-52-93

Россия (495)268-04-70

Казахстан (772)734-952-31

Киргизия (996)312-96-26-47